

---

epos

---

artistry in watchmaking  
switzerland



EPOS REF. 3429 - LIMITED EDITION

# EPOS REF. 3429 MANUAL - SWISS MOVEMENT UNITAS 6498

Please closely follow the instructions below in order to keep the watch undamaged.

## To extract the pocketwatch-container from the strap-case:

1. Unfasten the small 9H-crown (A) by screwing it counterclockwise
2. Unfasten the 3H-crown (B) by screwing it counterclockwise
3. Extract the pocketwatch-container when both crowns are fully unfastened

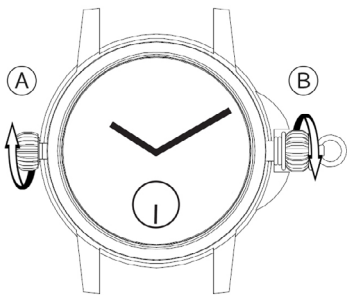

## You can now use the container as a pocket watch:

1. Please refasten both crowns as soon as the container is extracted
2. Fasten the small 9H-crown (A) by pushing it down and screwing it clockwise
3. Fasten the 3H-crown (B) by pushing it down and screwing it clockwise

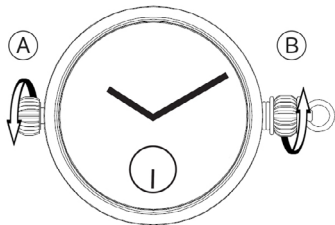

## Alternatively, you can use the container as a table watch:

1. Please refasten both crowns as soon as the container is extracted
2. Fasten the small 9H-crown (A) by pushing it down and screwing it clockwise
3. Fasten the 3H-crown (B) by pushing it down and screwing it clockwise
4. Expand the stand in the back of the container



## To reinsert the pocketwatch-container into the strap-case:

1. Unfasten the small 9H-crown (A) by screwing it counterclockwise
2. Unfasten the 3H-crown (B) by screwing it counterclockwise
3. Make sure that both crowns are completely unfasten
4. Carefully insert the container into the strap-case. Make sure that the container is kept perfectly straight

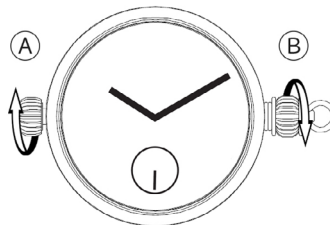

# EPOS REF. 3429 MANUAL - SWISS MOVEMENT UNITAS 6498

## You can now use it as a wristwatch:

1. Please refasten both crowns as soon as the container is reinserted
2. Fasten the small 9H-crown (A) by pushing it down and screwing it clockwise
3. Fasten the 3H-crown (B) by pushing it down and screwing it clockwise
4. Please make sure that the crowns are fully fastened to ensure a tight fit of the container. Otherwise, the container might fall out.

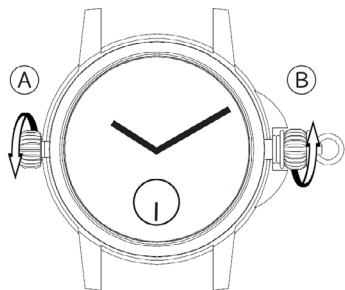

## Handling and corrections: Manual winding

1. Unfasten the screwdown-crown by screwing it counterclockwise
2. Manual winding by screwing the crown clockwise
3. Fasten the screwdown-crown by pushing it down and screwing it clockwise

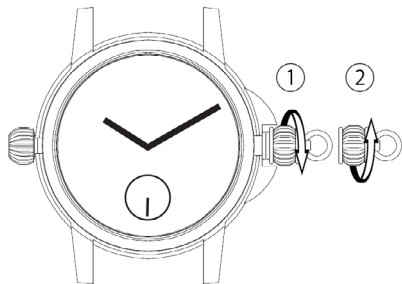

## Handling and corrections: Time setting

1. Unfasten the screwdown-crown by screwing it counterclockwise
2. Pull out the crown to pos. 2 for time-setting
3. Time-setting by screwing the crown clockwise or counterclockwise
4. Pull in the crown to pos. 1
5. Fasten the screwdown-crown by pushing it down and screwing it clockwise

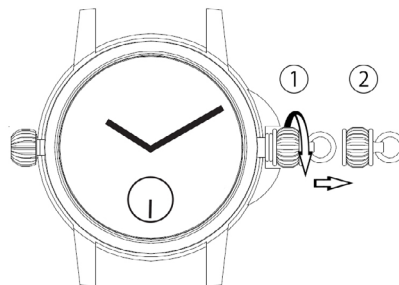

## Functions

Display by means of hands: hours, minutes, small second

## Technical specifications

Round caliber 16 $\frac{1}{2}$ '''  
Manual winding  
Power-reserve: max. 53 h  
21'600 vibrations per hour (3 Hz)  
Jewels: 17  
Movement diameter: 37.20 mm  
Movement height: 4.50 mm